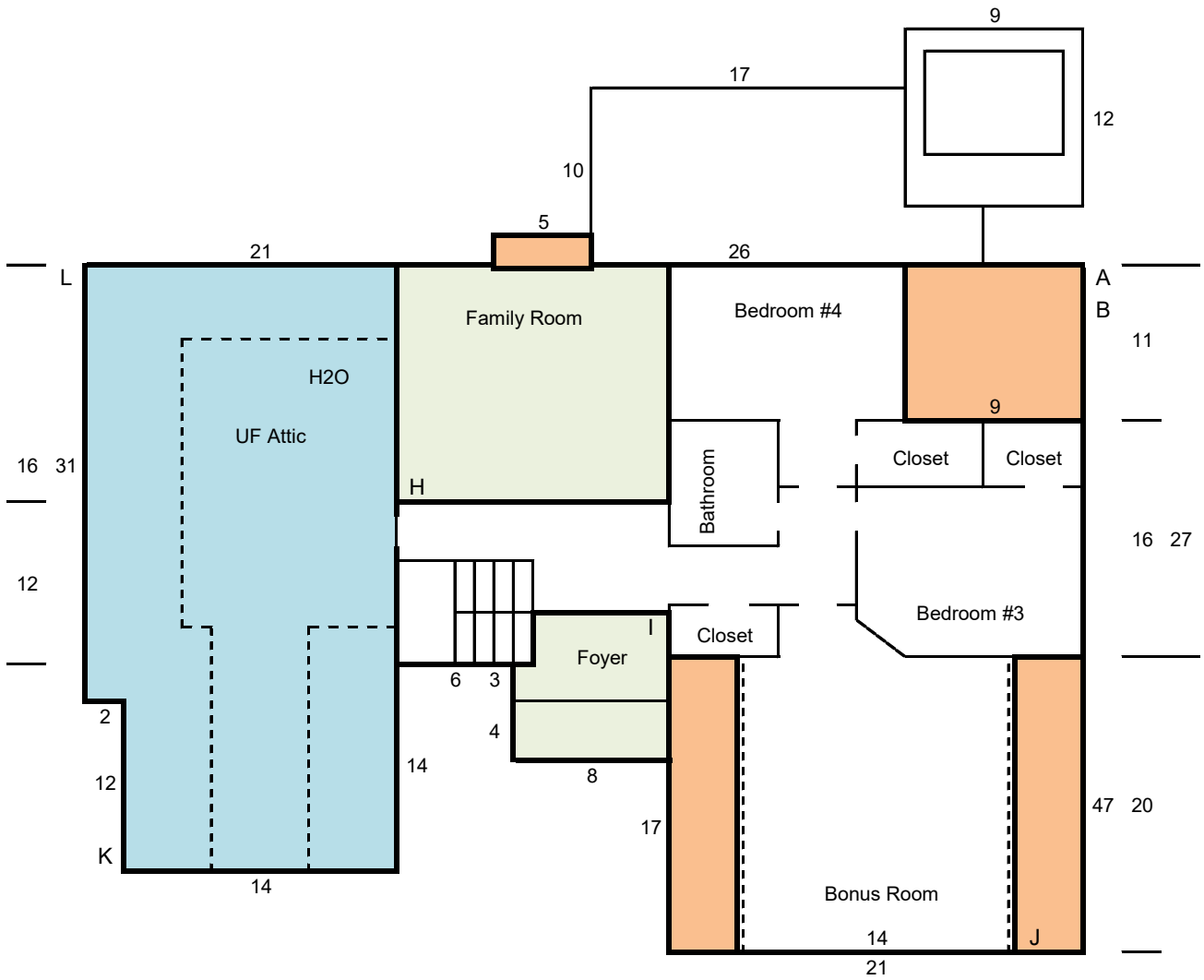
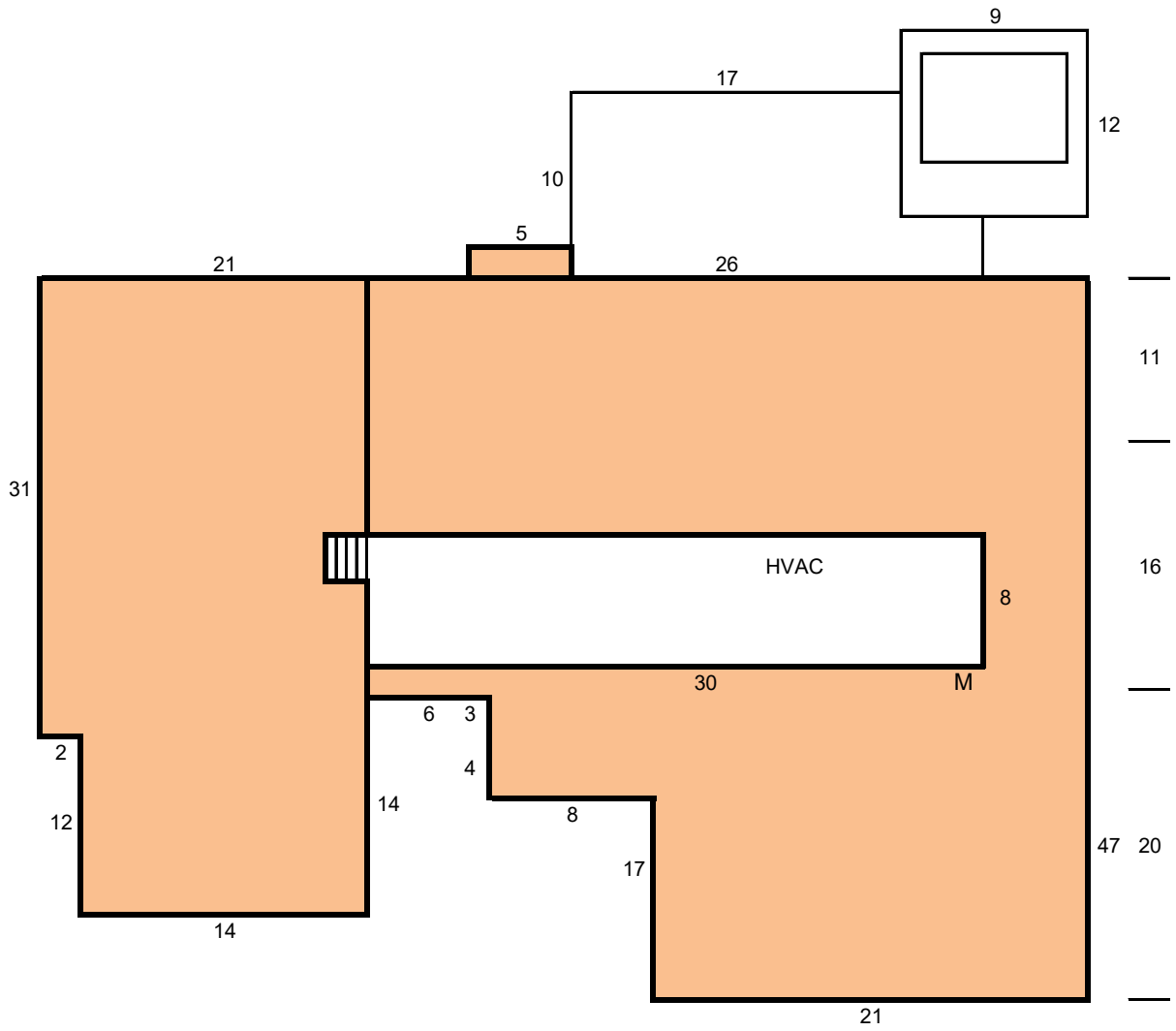

*Diagram Dimensions are Rounded



*Diagram Dimensions are Rounded



*Diagram Dimensions are Rounded

2/10/2025

104 Barnes Spring Court
Cary, N.C. 27519-6666

Room Dimensions
Calculations

M	Foyer	9.75 X 7.50	A	27.25 X 21.00 =	572.25
M	Closet	4.58 X 3.25	B _n	11.16 X 9.00 =	-100.44
M	Family Room	19.50 X 14.16	C	3.00 X 2.91 / 2 =	4.37
M	Dining Room	11.83 X 10.91	D _n	10.00 X 3.67 =	-36.70
M	Kitchen / Breakfast	20.50 X 11.58	E	30.58 X 30.16 =	922.29
M	Kitchen	11.58 X 10.58	F	6.25 X 2.67 =	-16.69
M	Pantry	2.91 X 1.67	G	14.00 X 11.58 =	162.12
M	Breakfast Room	9.91 X 8.91	Total Main Level Finished		<u>1507.20</u>
M	Laundry Room	6.08 X 5.91	A	27.25 X 21.00 =	572.25
M	Master Bedroom	15.33 X 13.33	B _n	11.16 X 9.00 =	-100.44
M	Master Bathroom	9.67 X 8.25	H	14.33 X 11.58 =	165.94
M	Master Closet	7.50 X 6.33	I _n	6.00 X 3.25 =	-19.50
M	Bedroom #2	11.00 X 10.58	J	20.08 X 14.58 =	292.77
M	Bedroom #2 Closet	5.75 X 2.25	Total 2nd Level Finished		<u>911.02</u>
M	Bathroom	7.50 X 4.91	Total Heated & Finished/		2418.22
M	Hallway Closet	4.91 X 1.58	K	15.67 X 13.25 =	207.63
M	Porch	7.83 X 4.41	L	26.00 X 14.33 =	372.58
M	Porch	11.16 X 9.00	Total 2nd Level UF Floored Attic		580.21
M	Deck	16.50 X 11.91	M	30.08 X 8.00 =	240.64
M	Deck	12.16 X 9.00	Total 3rd Level UF Floored Attic		240.64
M	Whirlpool	7.00 X 6.91	B	11.16 X 9.00 =	100.44
M	Garage	20.25 X 19.16	C _n	3.00 X 2.91 / 2 =	-4.37
2nd	Bedroom #3	11.50 X 10.50	N	7.83 X 4.41 =	34.53
2nd	Bedroom #3 Closet	4.91 X 4.58	Total Porches		130.61
2nd	Bedroom #4	12.16 X 11.00	O	16.50 X 11.91 =	196.52
2nd	Bedroom #4 Closet	6.25 X 4.58	P	12.16 X 9.00 =	109.44
2nd	Bathroom	8.25 X 5.00	Total Decks		305.96
2nd	Hallway Closet	4.91 X 3.00	D	10.00 X 3.67 =	36.70
2nd	Bonus Room	19.25 X 14.25	Q	21.00 X 20.08 =	421.68
2nd	Unfinished Floored Attic	41.16 X 14.33	Total Garage		458.38
3rd	Unfinished Floored Attic	30.08 X 8.00			